

PRODUCT HIGHLIGHTS

- Ideal for institutions, schools, parking garages, and stairwells
- Heavy-duty, low profile
- Polycarbonate lens resists breakage from abuse/severe impact
- Tamper-proof, spanner type screws discourage access to fixture interior

CONSTRUCTION - Fixture housing/socket plates, end plates & wireway cover constructed of code-gauge, die-formed, cold rolled steel. Wire way covers snap in for easy attachment/removal. Socket plates provide pressure retention of lampholders with no hardware required for attachment.

SHIELDING - Lens is .187" thick polycarbonate, with pyramidal prism pattern at bottom and vertical rib design at perimeter. Lens sealed with closed-cell gasketing. Fixture housing completely enclosed by lens assembly.

ELECTRICAL - All devices UL/CUL listed. Suitable for damp locations. Damp location emergency pack must be specified separately. Ballasts are solid-state electronic. Ballasts and lampholders replaceable without removing from ceiling. Discrete voltage must be specified for emergency pack options when wired with flex. Where lamps are included as part of the fixture, lamp CRI and color temperature must be specified.

PHOTOMETRICS - Please visit our web site at www.lsi-industries.com for detailed photometric data.

DIMENSIONS

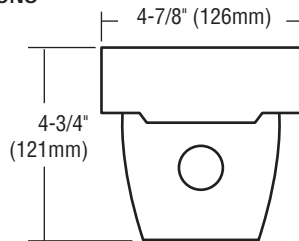

4 Foot

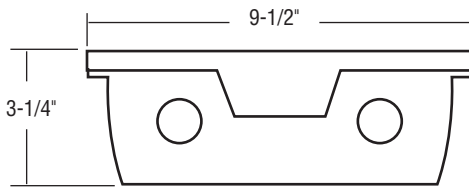

2 Foot or 4 Foot



LUMINAIRE ORDERING INFORMATION

TYPICAL ORDER EXAMPLE: **LIVL 1 32 SSO10 EM UE**

Prefix	Lamps	Lamp Type	Ballasts	Options	Voltage
LIVL	1	32 - 32W 48" T8 34 - 34W 48" T12	SSOD - T8 Dimming (Specify Type) SSOL - T8 Low Watt SSOHL - T8 High Power Factor SSOR - T8 Rapid Start SSO10 - T8 <10% THD Instant Start SS12 - T12 Electronic	F - Fusing EM - Emergency Pack EMDL - Emergency Pack - Damp Location	120 - 120V 277 - 277V 347 - 347V UE - Universal Electronic (120-277V)
	2	32 - 32W 48" T8			